

Brake Winch Cable Shortcut

Attaching the cable on to a brake winch is one of the most difficult parts of an entire gourd rack install. This short cut will make inserting the cable a quick and painless job.

Step 1) You will need to remove the bolt that holds the brake winch DRUM into place. To do this you will need 2, ½” wrenches, one to hold the nut, the other to loosen the bolt.

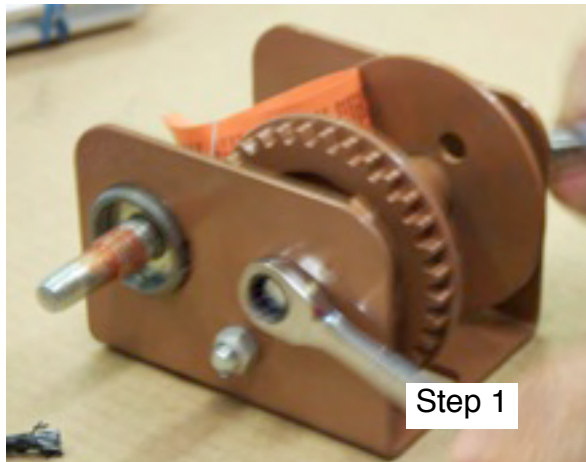

Step 2) Remove the drum from the carriage. Note the sleeve (see arrow) inserted thru the center of the drum. It is removable and should it fall out set it aside.

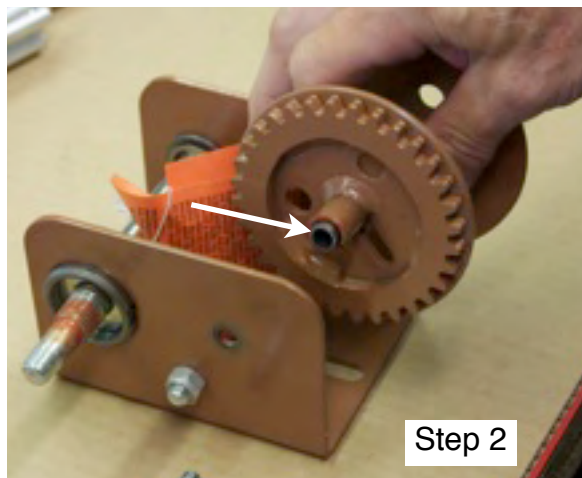

Step 3) You now have access to the 3 small holes on one end of the drum.

Take the end of your cable and insert the cable into the OVAL shaped hole first.

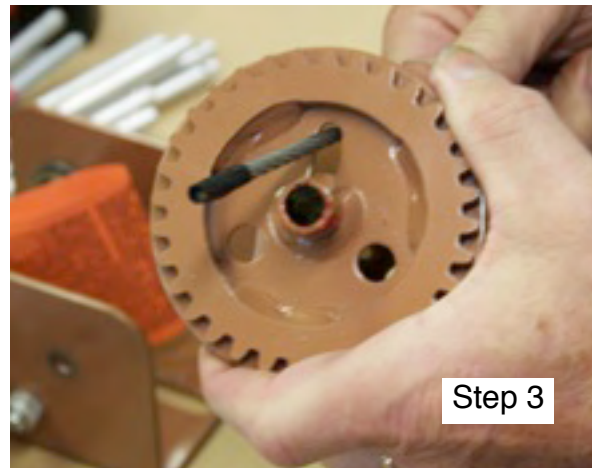

Step 4) Bring your cable up and over to the the round hole to the left, placing the end of the cable into the drum.

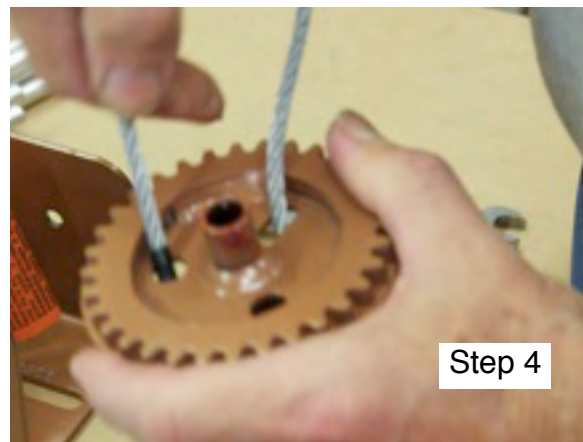

Step 5) Then bring the end of the cable from inside the drum thru the last unused hole on the drum.



Brake Winch Cable Shortcut

Step 6) The end of the cable needs to be locked down and held into place. Do this by using your thumb and holding the end of the cable down against the inner depressed circle of the drum.



Step 7) The cable that is inside the drum, grasp it and pull removing the slack. Your cable should look exactly like the photo.

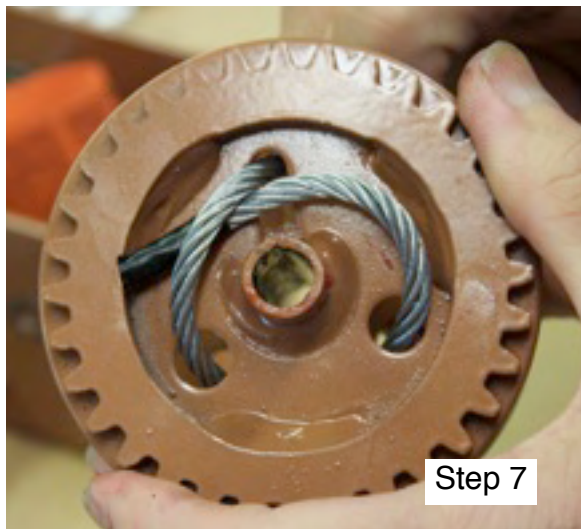

Step 8) If your sleeve came out replace it and then place the drum back into the carriage. Install the bolt and nut and tighten.

Thread the cable on to the drum follow the directions that came with your winch.

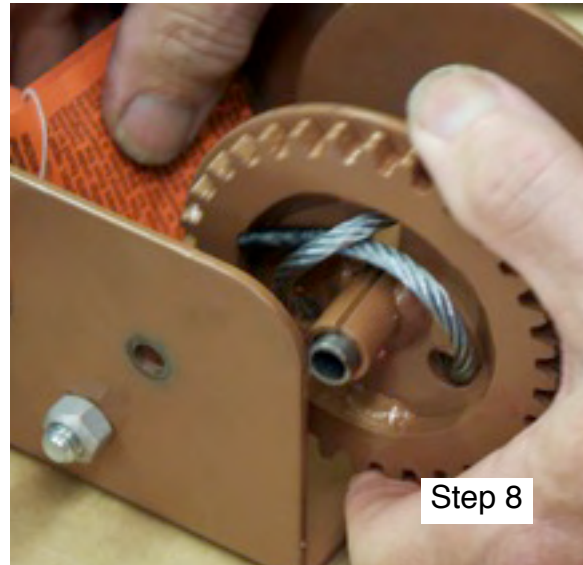

On occasion brake winches bind. We spray on gear and wire lubricant, but be forewarned. DO SO AT YOUR OWN RISK. If you add this lubricant, do so sparingly. Always make sure your safety bolt is in place. Never let children play around brake winches.

